

# WP-Compact Series

## DC Power Distribution

300 Amps Continuous Rating Manual Battery Switches



Datasheet



### **No compromise in safety and reliability, Around the battery**

When leaving the marina and heading for the ocean, you are getting fully dependent on your boat electrical system. With WhisperPower, you are secured electricity is guided into the appropriate conduits which prevents dangerous situations. The WhisperPower DC distribution program offers high quality components ensuring a safe and enjoyable trip.

- Robust and compact design
- Tin-plated copper studs for maximum conductivity and corrosion resistance
- Multiple cable terminals, 22mm stud length
- One piece terminal design prevent loosens over time
- Multiple cable input, allows surface, rear, or front panel mounting options.
- Circuit identification label included
- Ce marked, Iso 8846
- UI listed- UL1701 electrical power switches
- Meets American Boat and Yacht Council requirements
- Meets UI1500 and SAE J1171 external ignition protection requirements
- IP66- protected against powerful water jets

When setting up the battery banks of your 12 or 24V system, the required capacity and choice of battery type are not the only important elements. Vital components around the battery are at least as important. WhisperPower provides you with all the necessary high quality components to perfectly round off your installation. WhisperPower offers a complete program of manual and remote operated battery switches.

Manual operated WP-Compact series or WP-Heavy Duty series, manual ON/OFF switches to connect/disconnect DC consumers and/or battery bank.

Remote operated – WP-ML Bi-stable low current draw remote battery switch/magnetic latch, for remote ON and off switching of the DC consumers and/or battery bank.



green energy solutions



green energy solutions



| Series Article no.               | WP-Compact Series 50214701 | WP-Compact Series 50214702 | WP-Compact Series 50214703 |
|----------------------------------|----------------------------|----------------------------|----------------------------|
| Model type                       | Manual battery switch      | Manual battery switch      | Manual battery switch      |
| Circuit type                     | on-off                     | dual circuit               | dual circuit + combine     |
| <b>Input</b>                     |                            |                            |                            |
| Battery input                    | 1                          | 2                          | 2                          |
| Switch Positions                 | 2                          | 4                          | 3                          |
| Battery combine function         | -                          | yes                        | yes                        |
| I 10 Cranking rating 10 sec      | 1500 A                     | 1500 A                     | 1500 A                     |
| I 60 Cranking rating 1 min       | 775 A                      | 775 A                      | 775 A                      |
| I 300 Cintermittent rating 5 min | 500 A                      | 500 A                      | 500 A                      |
| I C continue rating              | 300 A                      | 300 A                      | 300 A                      |
| Vmno Voltage maxium Operation    | 48VDC                      | 32VDC                      | 32VDC                      |
| <b>General</b>                   |                            |                            |                            |
| Ambient operation temperature    | -20 C ... +40C             | -20 C ... +40C             | -20 C ... +40C             |
| Storage temperature              | -25 C ... +85C             | -25 C ... +85C             | -25 C ... +85C             |
| Operating humidity               | 95%, non condens           | 95%, non condens           | 95%, non condens           |
| <b>Mechanical</b>                |                            |                            |                            |
| Connections terminal stud        | M10 (3/8"-.16)             | M10 (3/8"-.16)             | M10 (3/8"-.16)             |
| Connections stud lenght          | 22 mm                      | 23 mm                      | 24 mm                      |
| Maximum terminal Stud Torque     | 13.56 NM (120 in-lb)       | 13.56 NM (120 in-lb)       | 13.56 NM (120 in-lb)       |
| Terminal material                | tin-plated copper          | tin-plated copper          | tin-plated copper          |
| Enclouser width                  | 72 mm                      | 72 mm                      | 72 mm                      |
| Enclouser height                 | 78 mm                      | 78 mm                      | 78 mm                      |
| Weight                           | 0.28 kg                    | 0.28 kg                    | 0.28 kg                    |
| Drilling mounting centers        | 55 mm                      | 56 mm                      | 57 mm                      |
| Rear panel mount diameter        | 59 mm dia                  | 60 mm dia                  | 61 mm dia                  |
| Mounting screws                  | 10 mm                      | 11 mm                      | 12 mm                      |
| Ingress Protection Class         | IP66                       | IP67                       | IP68                       |
| Enclouser Colour                 | RAL9011 Graphite Black     | RAL9011 Graphite Black     | RAL9011 Graphite Black     |
| Calbe clearance                  | 28 mm (1.12")              | 29 mm (1.12")              | 30 mm (1.12")              |
| Ignition Protection              | UI 1500 SAE J1171          | UI 1500 SAE J1172          | UI 1500 SAE J1173          |
| Markings                         | CE, Iso 8846               | CE, Iso 8847               | CE, Iso 8848               |

### Circuit type on-off

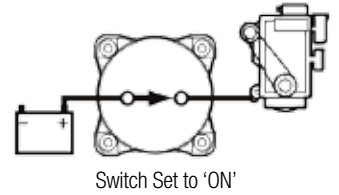

### Circuit type dual circuit

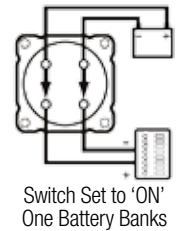
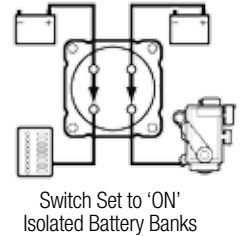

### Circuit type dual circuit + combine

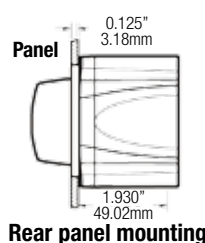
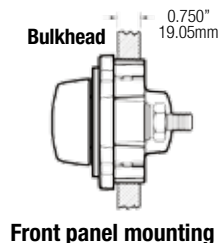
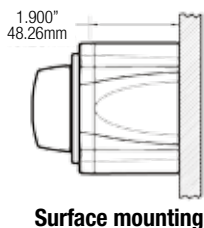
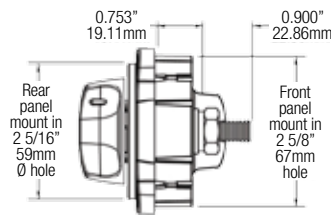
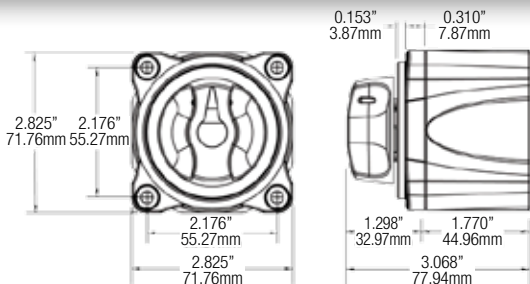
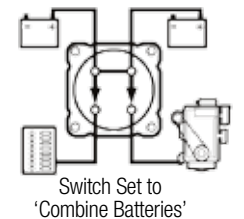
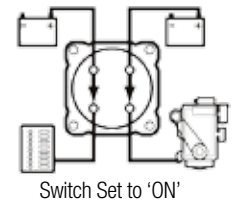

**Switch Mounting Options**