



USERS MANUAL

BSI



Art.nr. 40200891

WHISPER POWER BV
Kelvinlaan 82
9207 JB Drachten
Netherlands
Tel.: +31-512-571550
Fax.: +31-512-571599
www.whisperpower.eu

V1. November 2011

CONTENTS:

1	INTRODUCTION	4
1.1	General	4
1.2	General ideas over batteries	4
1.1.1	Defining the capacity	4
1.2.2	Capacity and temperature	4
1.2.3	Capacity and cells imbalance	4
1.2.4	Capacity and discharge current	4
1.2.5	Capacity over the battery lifetime	4
1.3	Conventions	5
1.3.1	Symbols.....	5
1.3.2	Regarding the parameters	5
1.4	Warranty and liability	5
1.4.1	Warranty and liability	5
1.4.2	Exclusion of warranty	5
1.4.3	Exclusion of liability	5
1.5	Safety precautions.....	5
1.5.1	Exclusion of liability	5
1.5.2	Warnings	5
1.5.3	Precautions while using batteries	6
2	DECLARATION OF CE CONFORMITY	7
3	DIMENSIONS	8
3.1	Views of different sides with dimensions	8
3.2	Exploded view	9
4	INSTALLATION	10
4.1	Mounting	10
4.2	Shunt mounting	10
4.3	Cabling	11
4.4	Connecting the communication bus	11
5	QUICK START GUIDE	12
5.1	Choosing the battery capacity	12
5.2	Choosing the shunt	12
5.3	Reset the battery history to zero.....	12
6	DISPLAY OF THE STATE OF THE BATTERY	13
6.1	Battery monitor	13
6.2	Graph of the state of charge history	13
6.2	Values to display	13
7	SETTING OF THE PARAMETERS	15
7.1	Generalities	15
7.2	Levels of use and of accessibility	15
7.3	General menu {6000}	15
7.3.1	Nominal capacity {6001}.....	15
7.3.2	Nominal discharge time (C-rating) {6002}.....	15
7.3.3	Nominal current of the shunt {6017}	15
7.3.4	Nominal voltage of the shunt {6018}.....	15
7.3.5	Reset to zero of the battery history {6003}	15

7.3.6	Restore the default settings {6004}.....	15
7.3.7	Restore the factory settings {6005}.....	15
7.4	Advanced menu	15
7.4.1	Zero resetting of users counters {6031}.....	15
7.4.2	Self discharge coefficient {6019}	15
7.4.3	Nominal temperature {6020}.....	15
7.4.6	Peukert exponent {6023}	15
7.4.7	Activating the end of charge synchronization {6042}	15
7.4.8	End of charge voltage threshold {6024}.....	16
7.4.9	End of charge current threshold {6025}	16
7.4.10	Minimum time before end of charge {6026}.....	16
8	FACTORY SETTING VALUES	17
9	TECHNICAL DATA.....	18
10	INDEX	19
10.1	Symbols	19

1 INTRODUCTION

1.1 GENERAL

The BSI (Battery Status Interface) is designed to monitor lead-acid batteries used with inverter-chargers of the WPC range. An advanced algorithm provides the battery state of charge in real time in order to best optimize its use.

The BSI offers voltage measurement for 12, 24 and 48 V nominal batteries as well as current measurement with a resistive shunt. Thanks to the WPC communication bus, the BSI is able to communicate with the other devices of the system. The remote control WPC-PSCP/RCC makes it possible to configure the BSI and to display the values that it measures. More than this, the WPC inverters can react according to various data given by the BSI.

1.2 GENERAL IDEAS OVER BATTERIES

The lead-acid batteries are energy storage with a complex behaviour. They consist of 2 Volt (V) nominal cells in series to reach the required voltage. Due to different physical and chemical phenomenons they can show, depending on the conditions, a behaviour quite far from the reservoir that simply fills up and empties out. This is the reason why the battery state of charge is complex to determine and why a lead-acid battery monitor is not as precise as, say, a petrol gauge.

The different values that affect a battery are described here below.

1.1.1 Defining the capacity

The battery capacity is defined as the quantity of electrical charge that a full battery can supply at given current before reaching a certain voltage. The unit generally used is the Ampere-hour (Ah). An ideal battery of 100 Ah will for instance supply 10 Amperes (A) during 10 hours or 1 A during 100 hours.

The capacity is usually given for a new battery, at 20 °C, with a discharge down to 1.8 V per cell (10.8 V for 12 V nominal, 21.6 for 24 V and 42.3 V for 48 V). The time of discharge is given by the letter C followed by the duration in hours, like C10 for 10 hours.

Capacity report with a Peukert coefficient of 1.25

Discharge speed	Capacity at C10 (100 Ah at 10 A during 10 hours)
C3	0.74
C20	1.19
C50	1.50
C100	1.78

To make them reach the given capacity, the manufacturers charge their batteries according to standard procedures (for instance as per the norm IEC-60896-11). This kind of charge can last up to many tens of hours at very high voltages, which is rather far from normal conditions of use. This is why the real available capacity is lower than what is given by the manufacturer.

1.2.2 Capacity and temperature

The capacity varies according to the temperature of the active substance of the battery. A decrease of the temperature will lead to a decrease of the capacity and an increase of the temperature to an improvement of the capacity.

1.2.3 Capacity and cells imbalance

The capacity varies according to the temperature of the active substance of the battery. A decrease of the temperature will lead to a decrease of the capacity and an increase of the temperature to an improvement of the capacity.

1.2.4 Capacity and discharge current

The capacity goes down when it comes to big discharge currents. The active substance in the battery needs time to spread into the cells and a quick discharge will lead to a capacity decrease.

To convert the capacity from a discharge duration to another, one can use Peukert formula.

$$C = C_{ref} \cdot \left(\frac{I}{I_{ref}} \right)^{n_{peukert}}$$

1.2.5 Capacity over the battery lifetime

The capacity decreases along the charge-discharge cycles. The deep discharges have a particularly negative impact. High ambient temperatures lower also the lifetime.

1.3 CONVENTIONS

1.3.1 Symbols



This symbol is used to indicate the presence of a dangerous voltage that is sufficient to constitute a risk of electric shock.



This symbol is used to indicate a risk of material damage.



This symbol is used to indicate information that is important or which serves to optimize your system.

1.3.2 Regarding the parameters

All values mentioned hereafter, followed by a parameter number indicate that this value may be modified using the WPC-PSCP/RCC remote control. In general, the default values are not mentioned and are replaced by a parameter number in the following format: {xxx}. The default values for this parameter are specified in the defaults parameter table Chapter 8: "Factory setting values" (p. 17).

1.4 WARRANTY AND LIABILITY

1.4.1 Warranty and liability

During production and assembling, each BSI gets several controls and tests. They are carried out in full respect of fixed procedures. Each BSI is given a serial number allowing a perfect follow-up of the controls, in conformity with the specific data of every device. For this reason, it is very important to never remove the descriptive sticker bearing the serial number. The production, the assembling and the tests of each BSI are entirely carried out in our supplier factory. The warranty of this product depends on strictly following the instructions in this manual. The warranty period for the BSI is 5 years.

1.4.2 Exclusion of warranty

No warranty will be applied for damages caused by handling, operation or actions that are not described in this manual. Damages arisen from the following events are not covered by the warranty:

- Overvoltage on the device.
- Reverse polarity while connecting the battery.
- Liquid in the device or oxidation due to condensation.
- Failures due to a fall or to a mechanical shock.
- Modifications made without the explicit authorization of Whisper Power BV.
- Nuts or screws partially or insufficiently tight during installation or maintenance.
- Damages due to atmospheric overvoltage (lightning).
- Damages due to transport or improper packaging.
- Disappearing of original marking items.

1.4.3 Exclusion of liability

Installation, commissioning, use and maintenance of this device cannot be supervised by Whisper Power. For this reason, we do not accept any liability for the damages, the costs or the losses generated either by an installation that is not conforming to the prescriptions, by a defectuous operation or by a poor maintenance. The use of this device is under the responsibility of the end-user. This device is neither designed nor guaranteed for the supply of life support applications or any other critical application with potential risks for human beings or for the environment. We shall assume no liability for patent infringement or other third party rights involved in the use of this device.

1.5 SAFETY PRECAUTIONS

1.5.1 Exclusion of liability

Do read carefully all safety instructions before proceeding to the installation and commissioning of the device. Not respecting these instructions might constitute a lethal physical danger but can also damage the functionalities of the device. Therefore do keep this manual close to the device.



Do, for any installation, follow strictly the local and national norms and regulations in force.

1.5.2 Warnings

- This device is used together with a permanent energy source (battery bank) and can also receive an alternative source at its input. Before any handling it is then necessary to disconnect all energy sources from the device.
- Even when the device has been disconnected from its supply source, there might remain a dangerous voltage at the outputs. To avoid any accident, it is necessary, after disconnection, to wait at least 30 seconds before operating on the device.
- Never use this device in a place where explosions might occur. Do refer to the indications of the battery manufacturer to ensure of the compatibility of the battery with the device. The safety instructions of the battery manufacturer have to be followed strictly too!
- Wherever the installation, the person in charge of installation and commissioning must know perfectly the safety measures and the prescriptions in force in the country. Therefore, the whole maintenance must be carried out by a qualified staff.
- All components connected to this device must be conform to the laws and regulations in force. The persons without a written authorization from Whisper Power BV are forbidden to do any change, modification or repair whatsoever. Regarding authorized

modifications and replacements, only genuine components shall be used.

- This device is meant for a use only indoor and must under no circumstances stand in the rain, the snow or any other humid or dusty environment.
- In case of use in motor vehicles this device must also be protected against vibrations by absorbing components.

1.5.3 Precautions while using batteries

Lead acid batteries with liquid electrolyte produce a highly explosive gas during normal operation. No source of spark or of fire should be present in the closeness of the batteries. The batteries must be installed in a well

ventilated space and mounted so as to avoid accidental short circuits while connecting them.



Never charge frozen batteries!

During any work on batteries, a second person must be present in case a problem occurs that requires assistance. There should be within reach enough fresh water and soap for an immediate washing of the skin or the eyes in case of accidental contact with acid. Should it happen, they must be washed carefully during at least 15 minutes with cold water. It is then necessary to immediately consult a doctor.

2 DECLARATION OF CE CONFORMITY

EC Declaration of Conformity/Incorporation

In accordance with EN ISO 17050-1:2004

We Whisper Power BV, Kelvinlaan 82, 9207 JB Drachten, The Netherlands hereby declare that:

BSI

Model number: 500/1200

Serial Number: All serial numbers

are in conformity with the applicable requirements of the following documents:

Ref. No.	Title
EN 60950 2005	Low voltage directive 2006/95/EC
EN 61000-6-2 2005	Generic Emission directive 2004/108/EC
EN 61000-6-3 2007	
RoHS	RoHS directive 2002/95/EC

Signed by:

Name: Dr. R.E.Bosman,

Technical Director,
Drachten

Date:

Document ref. BSI

The technical documentation for the machinery is available from:
Whisper Power BV,
Kelvinlaan 82, 9207 JB Drachten , The Netherlands

3 DIMENSIONS

3.1 VIEWS OF DIFFERENT SIDES WITH DIMENSIONS



Figure 1: Views of different sides with dimensions

3.2 EXPLODED VIEW

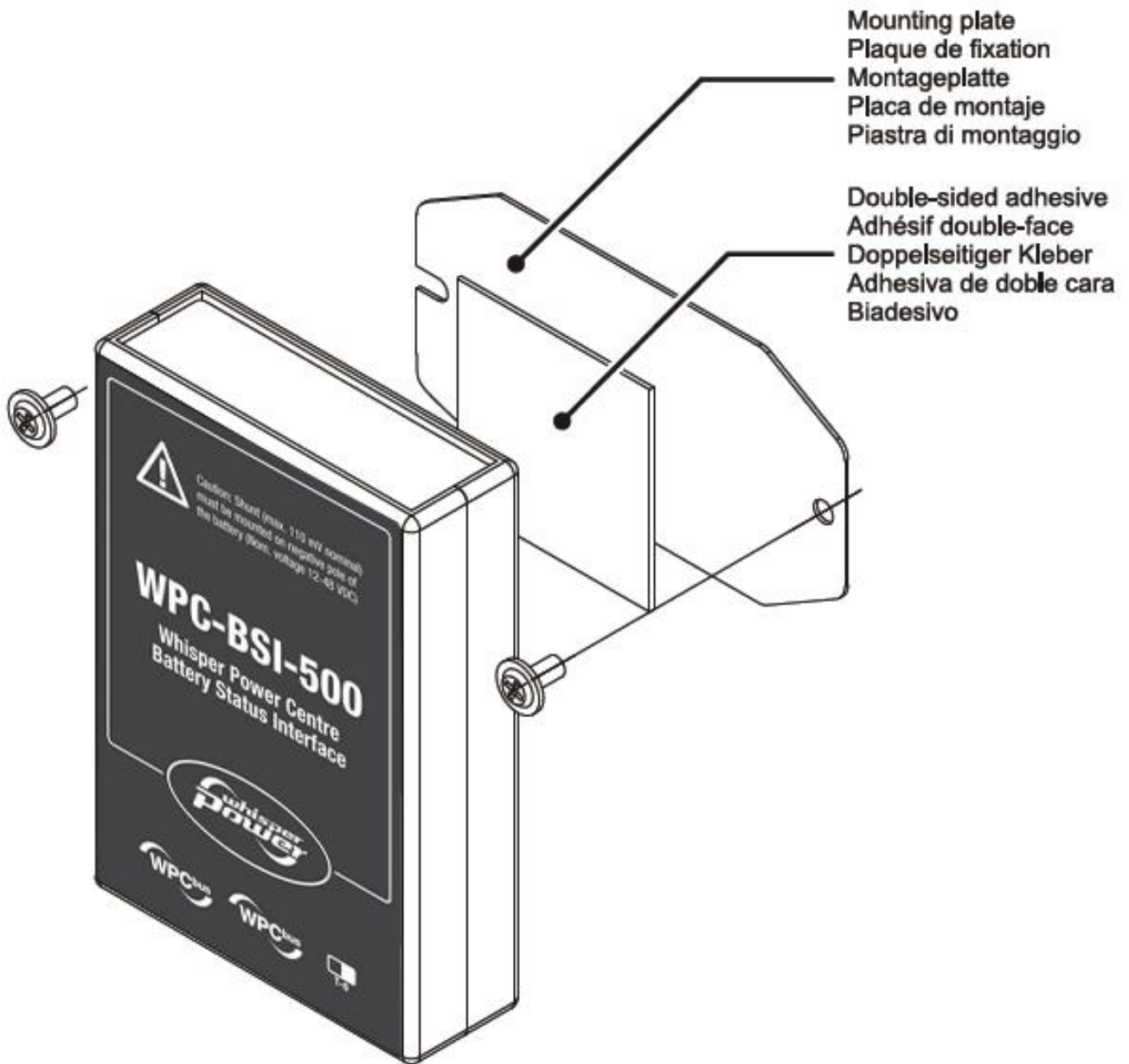

Figure 2: Exploded view

4 INSTALLATION

4.1 MOUNTING

The BSI must be mounted as close as possible to the battery. In this way, the measurement perturbations are minimized and the temperature sensor integrated in the box gives a more accurate measure of the battery temperature. If the BSI has to be installed in another room, it is possible to use the temperature sensor BTS that will be connected to the WPC. In that case the temperature of the BTS will be automatically taken into account for the state of charge calculation.

Ideally the BSI can be stuck directly to the battery. It can also be mounted close to the battery by means of the fixing plate supplied with (see figure 2). The direct mounting on the battery offers a more precise measurement of the battery temperature. While changing the battery bank, the BSI will have to be stuck again with a new double-side adhesive.



The BSI must be mounted so as to avoid any contact with acid from the battery. It should be taken care of fixing it vertically with the communication bus connectors downwards.

4.2 SHUNT MOUNTING

The shunt supplied with the device allows the measurement of the battery current. It must imperatively be installed in series with the negative terminal of the battery. The connection (a) of the figure 3 must be as short as possible. For a good operating of the charge estimating algorithm, all the current must go through the shunt. No other conductive component shall be connected to the negative terminal of the battery.



The shunt must be exclusively mounted on the negative terminal of the battery.

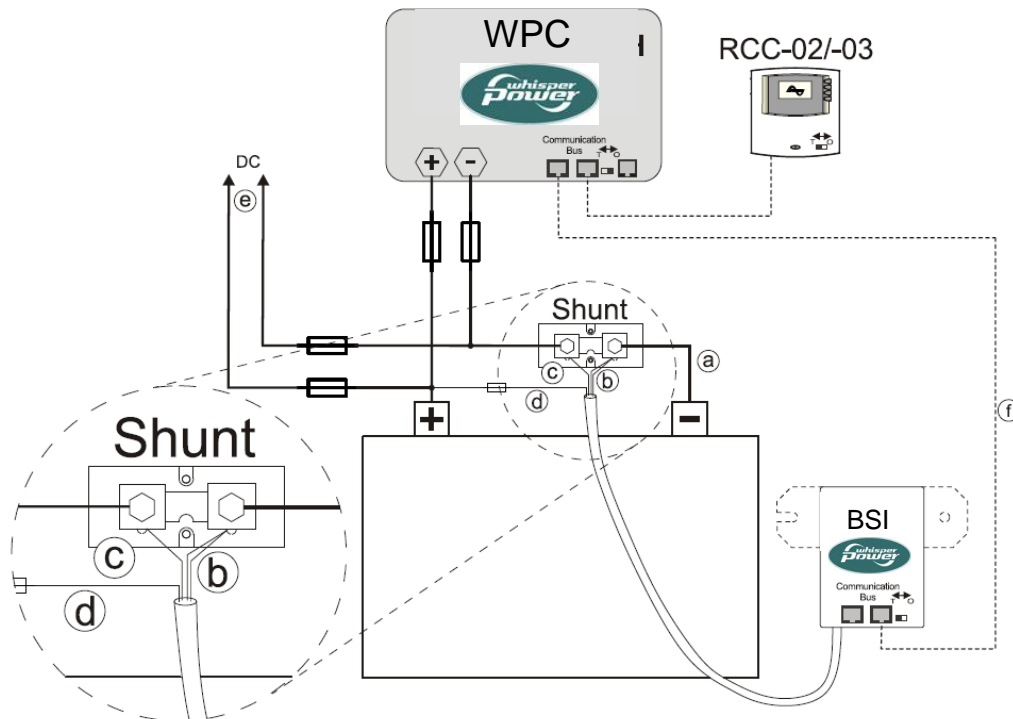

Figure 3: Connecting schematic of the BSI

4.3 CABLING

The cabling schematic is available on Figure 4.1. The cabling procedure is as follows:

1. Connect the shunt to the negative terminal of the battery (a). Beware of the cable cross section! All current (WPC + solar module(s) or consumer(s) directly connected to the DC side) will go through this cable for the charge and discharge of the battery.
2. Connect the white and yellow wires of the BSI cable to the screw of the shunt on battery side (b).
3. Connect the green wire of the BSI to the second screw of the shunt (c).
4. Connect the red wire with a fuse to the positive terminal of the battery (d).



It might happen while connecting the red wire to the battery that a spark is generated. No damage is likely to happen or to damage the device.

5. Connect the negative cables of the inverter, the solar regulator and/or DC consumers to the free bolt of the

shunt. The positive cables are being connected straight to the positive terminal of the battery (e).

6. Connect the communication cable to the communication bus of the WPC system and activate, if necessary, the linkend (f). For more information see the Section 4.4.

4.4 CONNECTING THE COMMUNICATION BUS

The devices of the WPC range are equipped with a owned communication bus (WPCbus) for data exchange, configuration and updating of the system. Connection is being made by linking the devices with the communication cables. One gets then a bus online where a link end must be activated on the devices on each end, to obtain the configuration of the Figure 3 . Each device is equipped with a switch offering to choose between open "O" or terminated "T". The devices at the end of the line must be set on "T" and all the others on "O".



A wrong setting of the link ends can lead to an erratic running of the installation or impede its updating.

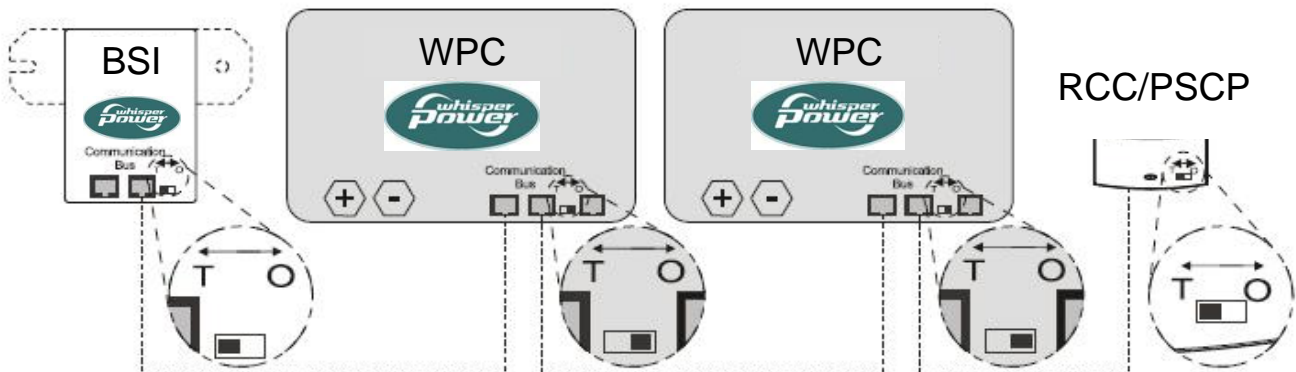

Figure 4: The communication bus online of the system WPC

5 QUICK START GUIDE

You will find in this chapter the procedure to follow in order to configure the BSI during installation. For the major part of the systems this is good enough. For a full list of the parameters that can be set do refer to Chapter 7.

5.1 CHOOSING THE BATTERY CAPACITY

The battery capacity must be configured. The manufacturer gives it at various discharge times (see Section 1.1). If several capacities at different times are supplied, the discharge time in 10 hours (C10) must be chosen because these are the reference conditions for the state of charge calculation. From the initial display of the RCC and by means of the keys UP and DOWN, move to the configuration menu of the BSI parameters, then push SET.



To modify the parameter "Battery Capacity" {6001}, move with the arrows UP and DOWN to the general menu.



Then push on SET to enter the menu. With the arrow DOWN, move to the parameter "Battery Capacity".

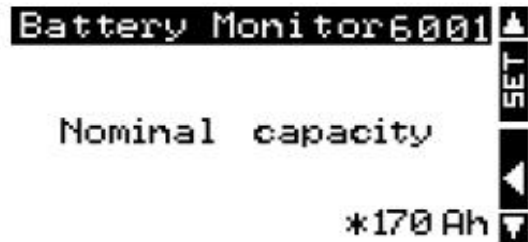

To modify its value push on SET. The value turns in reverse video.

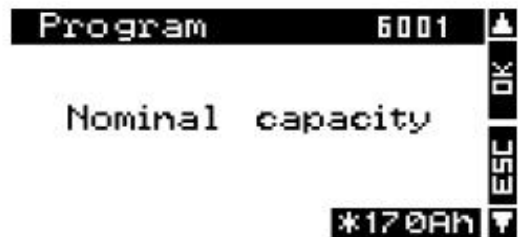

Change the value for the one of your battery with the keys UP and DOWN. Confirm by pushing on SET. Then, configure the parameter "Nominal Discharge Time(C-rating)" {6002} the same way as for the battery capacity.

5.2 CHOOSING THE SHUNT

If you are using a shunt supplied with the BSI-500, the BSI is configured for it and you can go directly to the next section.

Otherwise, the measuring shunt must be configured. The shunts are meant to supply a measuring nominal voltage at a nominal current. If you use the BSI-1200 shunt, the nominal current is 1200 A at 50 mV. If you use your own shunt, the current and the nominal voltage are given by the manufacturer and are often printed on the shunt.

The parameters "Nominal Current of the shunt" {6017} and "Nominal Voltage of the shunt" {6018} of the advanced menu enable to configure the BSI for a given shunt.

5.3 RESET THE BATTERY HISTORY TO ZERO

If you install the BSI for the first time or if the battery has been changed, you must reset the battery history to zero, by means of the parameter {6003}.

6 DISPLAY OF THE STATE OF THE BATTERY

6.1 BATTERY MONITOR

On installations with a BSI, the view over information on the battery of the Figure 6.1 is added to the WPC-PSCP/RCC. In area (A), four values of the BSI are displayed. The symbol of the battery in (B) gives a quick overview of the state of charge (SoC). The direction of the current is given in (C). An arrow upwards means the charge, downwards, the discharge.

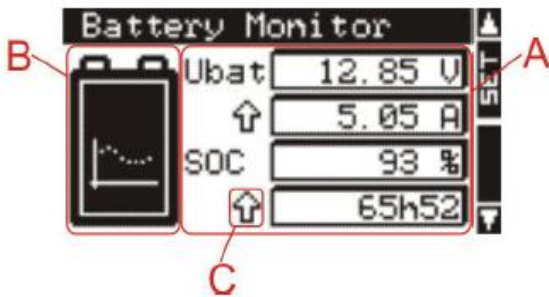

Figure 5: View of the state of the battery

6.2 GRAPH OF THE STATE OF CHARGE HISTORY

It is possible to see the battery state of charge of the last 5 days on the WPC-PSCP/RCC. On that purpose, from the view over the battery information, you enter in selection mode with the key SET. The battery is then selected as on the Figure 6.2. The key SET allows then to display the graph.

The graph of the state of charge of the Figure 6.3 is then displayed. On the horizontal scale are today and the last 4 days. The graduations indicate every hour from midnight to midnight. Each horizontal pixel means one hour. The vertical axis gives the state of charge of the battery. The graduations mean 20, 40, 60, 80 and 100 % and one pixel means 2 %.

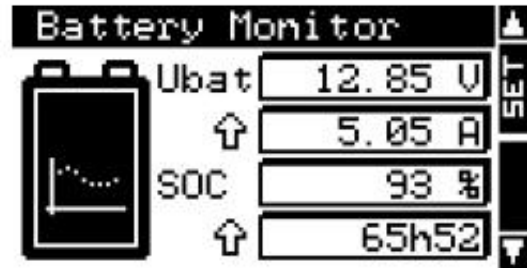

Figure 6: View with selected battery

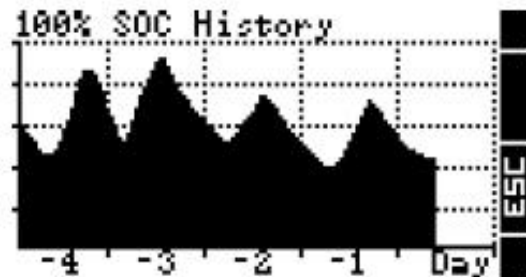

Figure 7: View of the state of charge history graph

6.2 VALUES TO DISPLAY

It is possible to modify the values to display on the battery view. For that, from the basic view of the Figure 6 push on SET. The battery is then selected as on the Figure 7. Go to the first value displayed with the key DOWN. The keys UP and DOWN allow going to the field to configure. With the key SET, enter the menu corresponding to the value to display. Then, choose the value to display by means of UP and DOWN and push on SET to validate.

At any time, to quit, use the key ESC that will bring you to the previous view.

The values available are the following:

Displayable values on the BSI view

Name of the value	Unit	Description
Battery voltage	V	-
Battery current	A	-
State of charge	%	-
Power	W	-
Time to go	hh:mm	During charging, this value indicates the time before the battery charge reaches 100 %. During discharging, it indicates the time before it reaches 0 %. This value is calculated on basis of the present current. What it gives is an indication. A variable energy consumption has of course a big impact on this value.
Battery temperature	°C	Temperature used to calculating the battery state of charge. Unless a BTS is connected to the WPC and therefore its value taken into account, this is the temperature measured inside the BSI that will be used.
Relative capacity	-	Ratio between the effective capacity of the battery and its nominal capacity.
Ah charged today	Ah	Charge supplied to the battery from midnight until now.
Ah discharged today	Ah	Charge supplied by the battery from midnight until now.
Ah charged yesterday	Ah	-
Ah discharged yesterday	Ah	-
Total kAh charged	kAh	Charge supplied to the battery from the last reset to zero of the battery history. See "Reset to zero of the battery history {6003}" (p. 20).
Total kAh discharged	kAh	Charge supplied by the battery from the last reset to zero of the battery history.
Total time	Days	Time since the last reset of the battery history.
Charge counting on the user side	Ah	This value offers to the user a charge and discharge measurement according to his needs. This counter, as the following two, can be reset to zero by means of the parameter "Zero resetting of users counters {6031}" (p. 21).
Discharge counting on the user side	Ah	-
Duration of the counting on the user side	Hours	-

7 SETTING OF THE PARAMETERS

A full list of accessible parameters can be found in Chapter 8.

7.1 GENERALITIES

The configuration is carried out on the WPC-PSCP/RCC by means of the BSP parameters menu. Generally the settings described in Chapter 5: "Quick Start guide" are enough for a good operation of the BSI. It is however possible to modify many other parameters described in this chapter.

7.2 LEVELS OF USE AND OF ACCESSIBILITY

The functions described below correspond to the level EXPERT. As per the user level selected, the access to all these functions might not be possible. Do refer to the chapter user level setting in the remote control manual for more information about this matter.

7.3 GENERAL MENU {6000}

The parameters for a basic configuration of the BSI are in this menu.

7.3.1 Nominal capacity {6001}

Battery nominal capacity. It is given for the nominal discharge time defined by the parameter {6002}.

7.3.2 Nominal discharge time (C-rating) {6002}

Discharge time used to give the battery nominal capacity of the parameter {6001}.

7.3.3 Nominal current of the shunt {6017}

This parameter enables to adjust the BSI measurement to the shunt. It must be set according to the nominal voltage of the shunt (parameter {6018}). For instance for the shunt 1200 A supplied with the BSI-1200, the setting will be 1200 A and 50 mV.

7.3.4 Nominal voltage of the shunt {6018}

See parameter {6017}.

7.3.5 Reset to zero of the battery history {6003}

This parameter enables to reset to zero all counters of the Section 6.2 and the algorithm during installation on a new battery.



This parameter should normally not be used if the battery has not been changed, because then the history (total current, estimated capacity) is lost.

7.3.6 Restore the default settings {6004}

Use this parameter to restore the initial settings of the BSI.



If your installer has made some settings at "installer" level while commissioning your installation, this function restores his settings and not the factory ones.

7.3.7 Restore the factory settings {6005}

With this function you can find the factory settings. For each parameter, not only the factory value is restored but also the limits and the user level. This function is only accessible with the level installer.

7.4 ADVANCED MENU

The advanced parameters for a BSI configuration.

7.4.1 Zero resetting of users counters {6031}

This parameter allows to reset to zero the charge, discharge and time user counters of the Section 6.2.

7.4.2 Self discharge coefficient {6019}

A battery gets discharged over time even when no current is consumed. This parameter allows to take this phenomenon into account.

7.4.3 Nominal temperature {6020}

The battery parameters are specified for a given temperature, which can be set by means of this parameter.

7.4.4 Temperature coefficient {6021}

The available capacity diminishes with the decrease of the temperature. This coefficient enables to take this factor into account.

7.4.5 Factor of charge efficiency {6022}

During charging, less Ah are stored into the battery than during discharging. The ratio discharge/charge can be set with this parameter.

7.4.6 Peukert exponent {6023}

The capacity varies according to the discharge current (see Section 1.4). With this parameter one can set the Peukert exponent that goes along with the nominal capacity {6001} and nominal discharge time.

7.4.7 Activating the end of charge synchronization {6042}

This parameter activates the function of synchronization at 100 % of SOC under certain conditions of end of charge. For the synchronization to occur:

- the voltage shall be above parameter {6024}
- the current shall be below parameter {6025}
- and this during a period defined by the parameter {6026}

This function is generally not necessary because the BSI adjusts automatically the state of charge as per the voltage.

7.4.8 End of charge voltage threshold {6024}

See explanation at parameter {6042}.

7.4.9 End of charge current threshold {6025}

See explanation at parameter {6042}.

7.4.10 Minimum time before end of charge {6026}

See explanation at parameter {6042}.

8 FACTORY SETTING VALUES

Factory setting values

Level	User ref.	Parameter	Unit	12 V		24 V		48 V	
				Factory Min	Max	Factory Min	Max	Factory Min	Max
Basic	6000	Basic settings							
Basic	6001	Nominal capacity	Ah	110	20000	110	20000	110	20000
Basic	6002	Nominal discharge duration (C-rating)	h	20	100	20	100	20	100
Basic	6017	Nominal's hunt current	A	500	10000	500	10000	500	10000
Basic	6018	Nominal shunt voltage	mV	50	200	50	200	50	200
Expert	6003	Reset of battery history		S	S	S	S	S	S
Basic	6004	Restore default settings		S	S	S	S	S	S
Inst.	6005	Restore factory settings		S	S	S	S	S	S
Expert	6016	Advanced settings							
Expert	6031	Reset of user counters		S	S	S	S	S	S
Expert	6019	Self-discharge rate	%/ month	3	25	3	25	3	25
Expert	6020	Nominal temperature	°C	20	40	20	40	20	40
Expert	6021	Temperature coefficient	%cap/ °C	.5	3	.5	3	.5	3
Expert	6022	Charge efficiency factor	%	80	100	80	100	80	100
Expert	6023	Peukert's exponent		1.25	1.5	1.25	1.5	1.25	1.5
Expert	6042	Activate the end of charge synchronization	No/ Yes	No	Yes	No	Yes	No	Yes
Expert	6024	End of charge voltage level	V	13.2	7.98	26.4	15.96	52.8	31.92
Expert	6025	End of charge current level	%cap	2	0	2	0	2	0
Expert	6026	Minimum duration before end of charge	s	240	300	240	300	240	300

9 TECHNICAL DATA

Specification

Supply voltage range	7..85 Vdc
Supply current	9 mA @ 12 V
	5 mA @ 24 V
	3 mA @ 48 V
Input voltage range	7..85 Vdc
Shunt measurement input range	±195 mV
RMS continuous current @ 25 °C	±500 A (BSI 500)
	±1200 A (BSI 1200)
Maximum measurable peak current	±1950 A (BSI 500)
	±4680 A (BSI 1200)
Voltage measurement accuracy	0.3 %
Current measurement accuracy	0.5 %
Battery capacity	20..20000 Ah
Operating temperature range	-20..55 °C
Packed weight	900 g (BSI 500)
	1500 g (BSI 1200)
Displayable values	see chapter 8
Protection degree	IP20
Conformity	LVD 2006/95/EC, EMC 2004/108/EC, RoHS 2002/95/EC EN 60950:2005, EN 61000-6-2:2005, EN 61000-6-3:2007

Readout resolution

Voltage	±0.01 V
Current (A) and capacity (Ah)	±0.01 (1..10)
	±0.1 (10..100)
	±1 (100..9999)
State of charge	±0.1 %
Temperature	±0.1 °C
Time to go	±1'

10 INDEX

10.1 SYMBOLS

- {6000} General menu, 15
- {6001} Nominal capacity, 15
- {6002} Nominal discharge time (C-rating), 15
- {6003} Reset to zero of the battery history, 15
- {6004} Restore the default settings, 15
- {6005} Restore the factory settings, 15
- {6016} Advanced menu, 15
- {6017} Nominal current of the shunt, 15
- {6018} Nominal voltage of the shunt, 15
- {6019} Self discharge coefficient, 15
- {6020} Nominal temperature, 15
- {6021} Temperature coefficient, 15
- {6022} Factor of charge efficiency, 15
- {6023} Peukert exponent, 15
- {6024} End of charge voltage threshold, 16
- {6025} End of charge current threshold, 16
- {6026} Minimum time before end of charge, 16
- {6031} Zero resetting of users counters, 15
- {6042} Activating the end of charge synchronization, 15



Kelvinlaan 82, 9207 JB Drachten, Netherlands
Tel : + 31-512-571550 / Fax : + 31-512-571599
www.whisperpower.eu / info@whisperpower.nl